

ADAMS HORIZONTAL AUTOMATIC STRAINER PARTS LIST

HWS-56 THRU 78

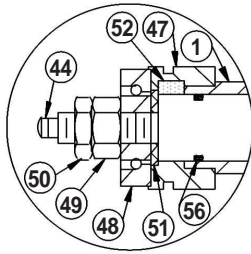

FIGURE 1

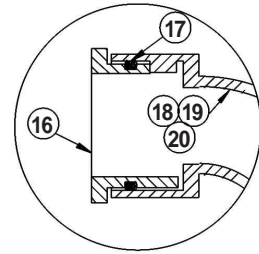
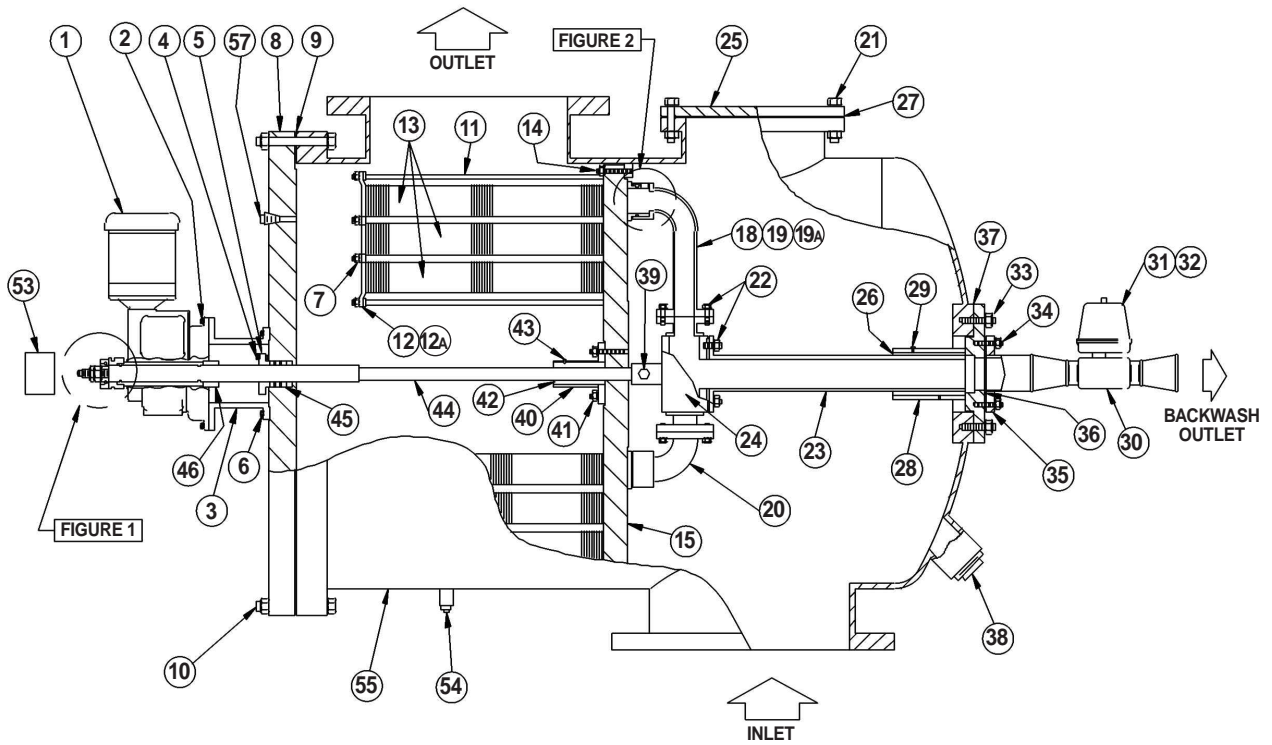

FIGURE 2



ITEM	DESCRIPTION	ITEM	DESCRIPTION	ITEM	DESCRIPTION
1	Gear Motor	19A	B/W Dist. Arm (Intermediate/Long) Assm.	38	Drain Plug, NPT
2	Gear Motor Bolt & Nut	20	B/W Dist. Arm (Short) Assm.	39	B/W Shaft Coupler Bolt & Nut
3	Gear Motor Mount	21	Inspection Open'g Bolt & Nut	40	Drive Shaft Brg. Housing
4	Stud, Nut & Washer	22	B/W Shaft Assm. Bolt	41	Dr. Shaft Brg. Stud & Nut
5	Packing Gland	23	B/W Shaft	42	Cutless Bearing
6	Cap Screw	24	B/W Shaft Tee	43	Set Screw-Cutless Bearing
7	Tube Support Rod Nut	25	Inspection Opening Cover	44	Drive Shaft
8	Cover	26	Cutless Bearing	45	Dr. Shaft Pkg. With Split Gasket
9	Cover Gasket	27	Inspection Opening Gasket	46	Stop Collar & Set Screw
10	Cover Bolt & Nut	28	B/W Bearing Housing	47	Shear Key Collar
11	Tie Rod	29	Brg. Set Screw	48	Thrust Bearing
12	Tie Rod Bar	30	B/W Ball Valve	49	Hex Nut (Reg.)
12A	Tie Pilate	31	B/W Valve Operator	50	Hex Nut (Jam)
13	Poro-Edge Tubes	32	B/W Valve Solenoid	51	Spacer
14	Tube Sheet Nut & Stud	33	B/W Flg Stud & Nut	52	Shear Key
15	Tube Sheet	34	B/W Outlet Flg. Stud & Nut	53	Dust Cap
16	Distributor Barrel Seal Plate	35	B/W Outlet Flange	54	Drain Plug, NPT
17	"O" Ring (Distributor Barrel Seal Plate)	36	B/W Outlet Flg. Gasket	55	Shell Assembly
18	B/W Dist. Arm (Long) Assm.	37	B/W Brg Housing Gasket	56	"O" Ring Gear Motor Seals (2 Req'd)
19	B/W Dist. Arm (Intermediate/Short) Assm.			57	Vent Plug NPT

Supersedes ST-51400 (2-11-99)



R. P. ADAMS COMPANY, INC.

www.rpadams.com

BUFFALO, NY USA

info@rpadams.com

ST-51400

DATE: 4-2-02